

Technical Product Specifications:

STRUT BRACKETRY

Approval/calculation possibilities:

- AS/NZS 4600:2018
- NZS 4100:2020
- NZS1170.5:2009
- NZS 4219:2009
- NZS 4541:2020
- AS/NZS 4680:2006



STRUT BRACKETRY

FDG stocks a wide range of Strut Channel Brackets, a crucial part of the modular nature of the FDG Channel System. The different brackets available allow you to create many different frames and assemblies to meet your support requirements. The Spring Nut fastening system creates a proven connection that gives strength and versatility to your build.

FDG Strut Brackets are critical for creating rigid seismic bracing assemblies. With a wide range of fixed and hinged brackets available this strong and easy to install bracing systems gives you the options you require. The FDG Strut Brackets are stocked standard as Hot Dip Galvanized, however are also available in ZP, Stainless Steel or painted finishes if required.

Advantages of using STRUT BRACKETRY

- Wide range of bracketry.
- Multiple combinations for assembly.
- Simple Spring Nut connection system.
- Easy to Install.
- Removes need for welding and drilling.

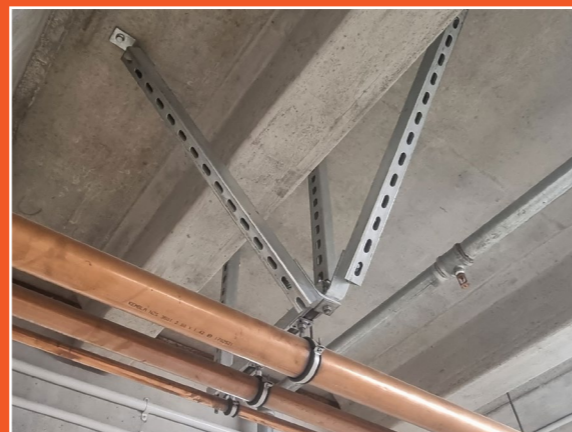
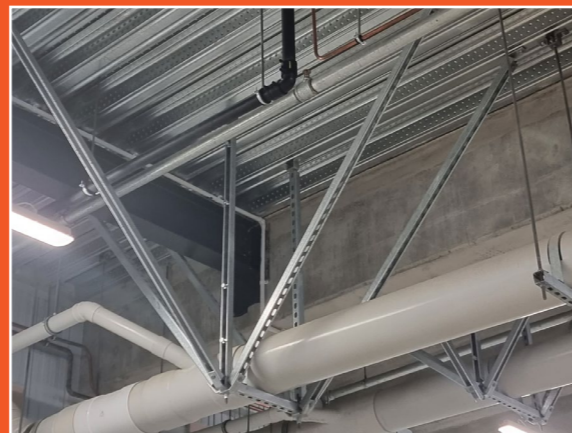

Contents

Spring Nut

- Safety Factor: 3
- Finishes Available: Zinc Plate, Hot Dip Galvanised, Stainless Steel SS316

Zinc Spring Nut			
Nut Type	Pullout	Slip (8.8 Bolts)	Torque
NUTM6SLSZ	2.70 kN	1.30 kN	9 Nm
NUTM8SLSZ	3.55 kN	2.20 kN	22 Nm
NUTM10SLSZ	4.45 kN	3.50 kN	44 Nm
NUTM12SLSZ	8.85 kN	6.50 kN	77 Nm

- Slip testing carried out in New Zealand using 8.8 Grade Zinc Bolts.
 - Strut Bracketing Capacity usually limited by Slip Capacity of Spring Nut.

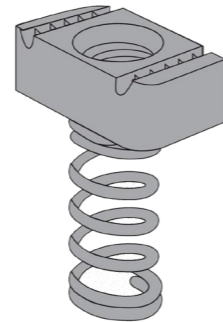

Flat Plate

- Hole Diameter: 14mm
- Hole Spacing (From End): 21mm
- Hole Spacing: 48mm
- Width: 40mm
- Thickness: 6mm
- Finish: Hot Dip Galvanised

Flat Plate

- Hole Diameter: 14mm
- Hole Spacing (From End): 21mm
- Hole Spacing: 48mm
- Width: 40mm
- Thickness: 6mm
- Finish: Hot Dip Galvanised

Square Plate Washers	
Code	Hole Size
W8X40SQX6G	M8
W10X40SQX6G	M10
W12X40SQX6G	M12
W16X40SQX6G	M16

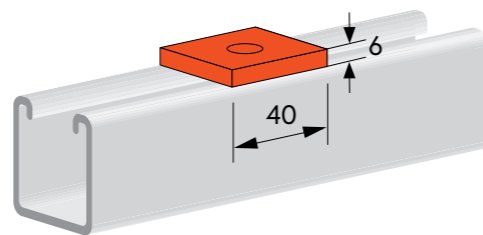

FDG1067G

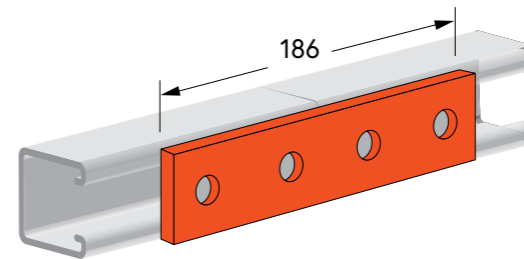

FDG1941G

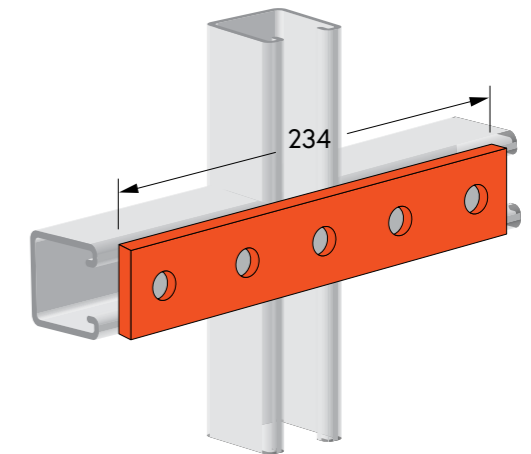

FDG1873G

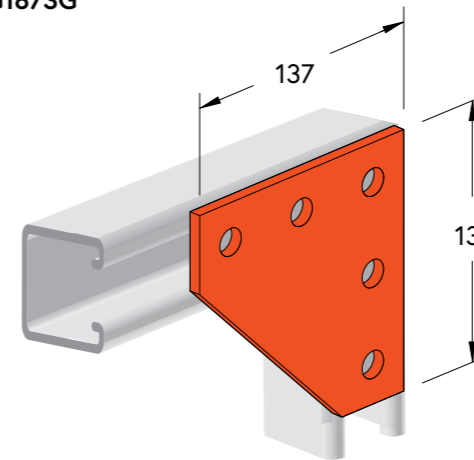

FDG1036G

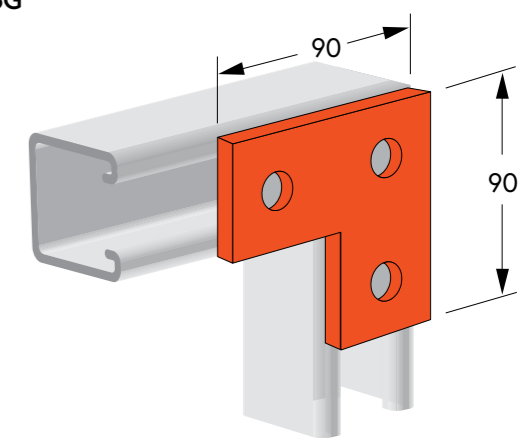

FDG1065G

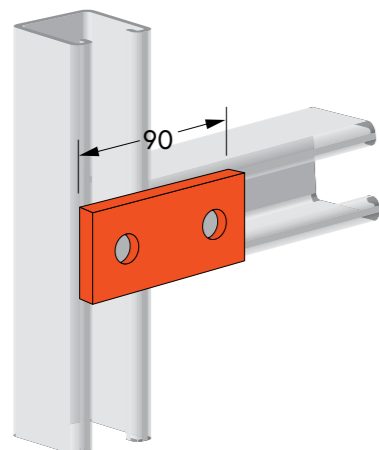

FDG1066G

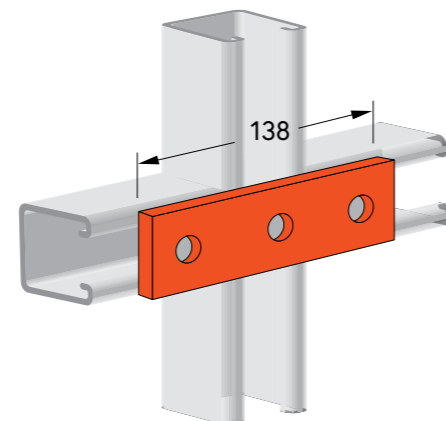

FDG2324G

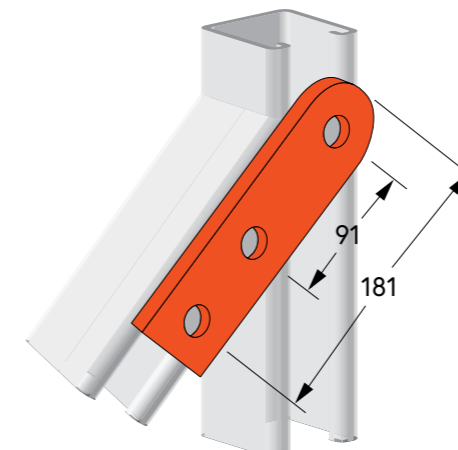

FDG2325G

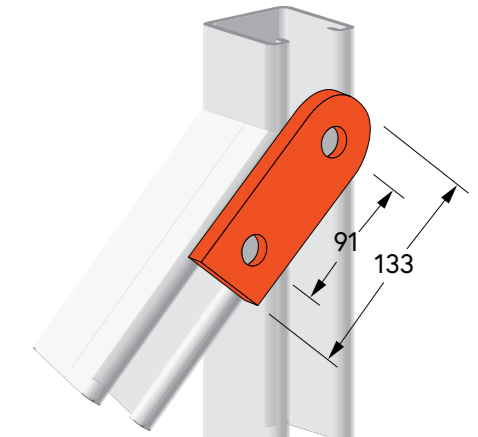

Flat Plate & 90° Angle

- Hole Diameter: 14mm
- Hole Spacing (From End): 21mm
- Hole Spacing: 48mm
- Width: 40mm
- Thickness: 6mm
- Finish: Hot Dip Galvanised

90° Angle

- Hole Diameter: 14mm
- Hole Spacing (From End): 21mm
- Hole Spacing: 48mm
- Width: 40mm
- Thickness: 6mm
- Finish: Hot Dip Galvanised

FDG1358G

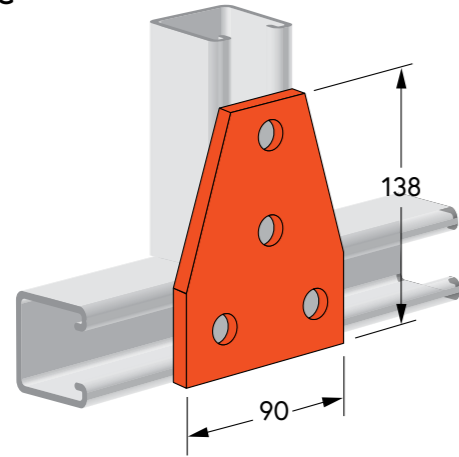

FDG1031G

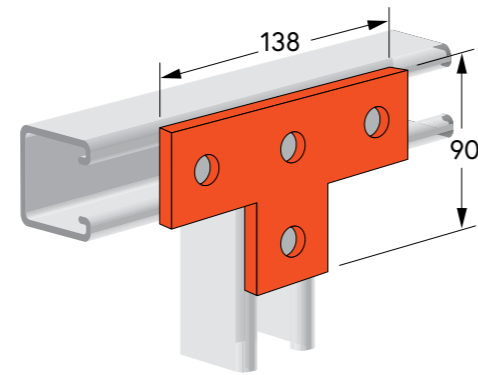

FDG1346G

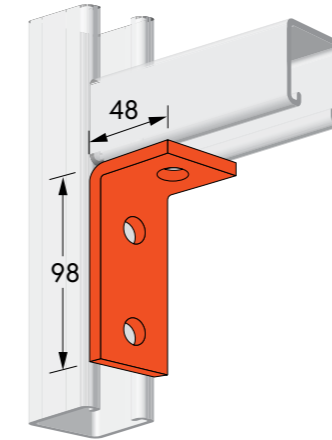

FDG1458G

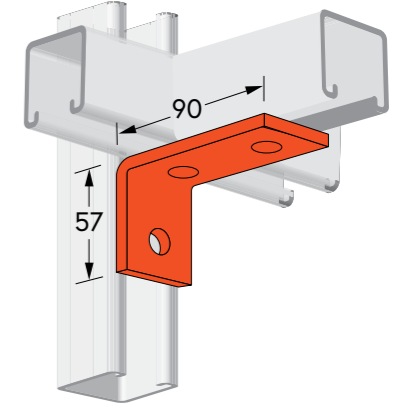

FDG1028G

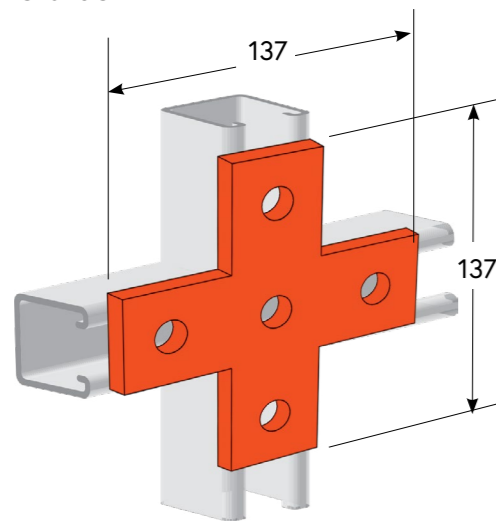

FDG1026G

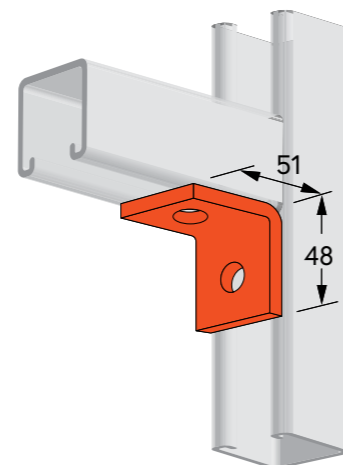

FDG1325G

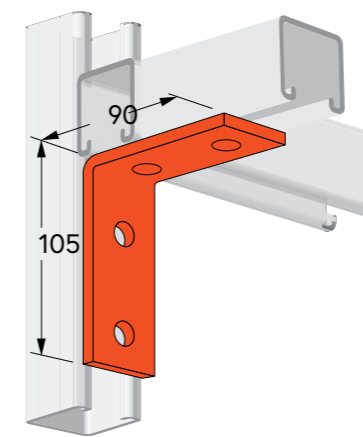

FDG2484G

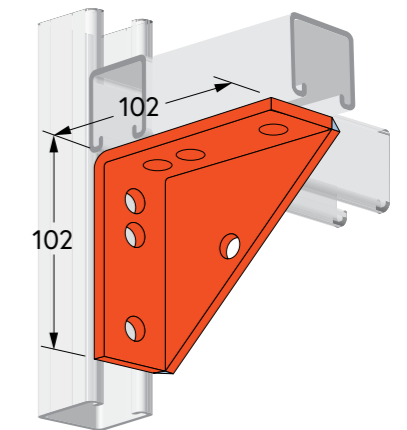

FDG1068G

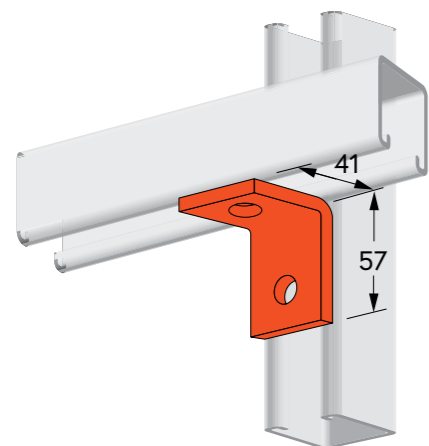

FDG1326G

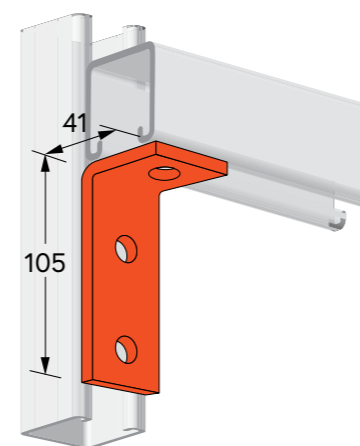

FDG1037G

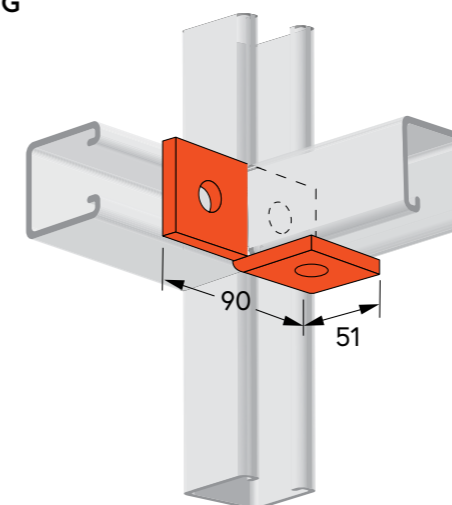

FDG1038G

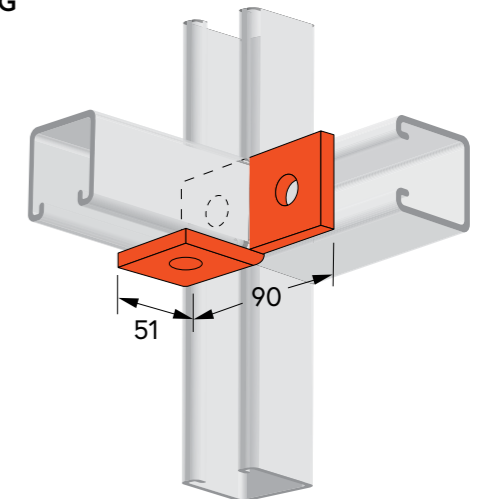

90° & 45° Angle

- Hole Diameter: 14mm
- Hole Spacing (From End): 21mm
- Hole Spacing: 48mm
- Width: 40mm
- Thickness: 6mm
- Finish: Hot Dip Galvanised

45° Angle

- Hole Diameter: 14mm
- Hole Spacing (From End): 21mm
- Hole Spacing: 48mm
- Width: 40mm
- Thickness: 6mm
- Finish: Hot Dip Galvanised

FDG1033G

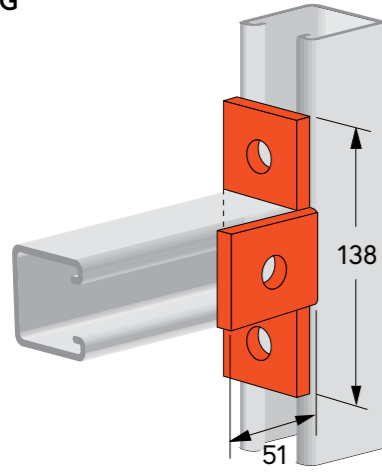

FDG1034G

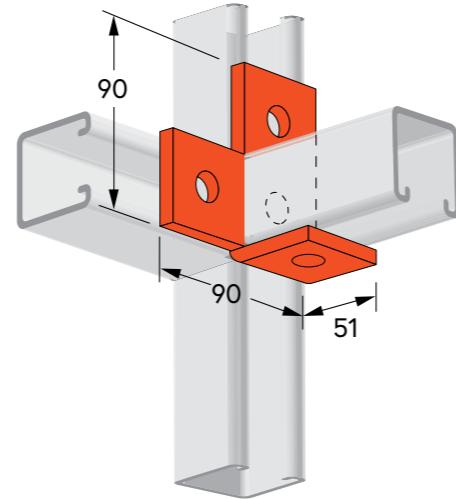

FDG1546G

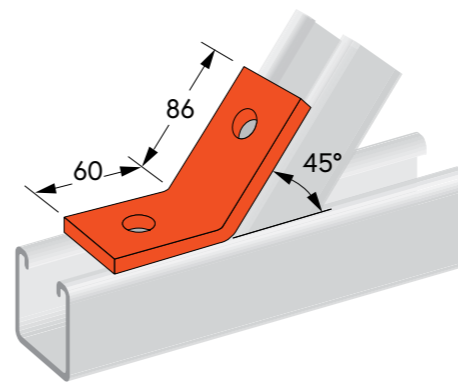

FDG1546G-3H

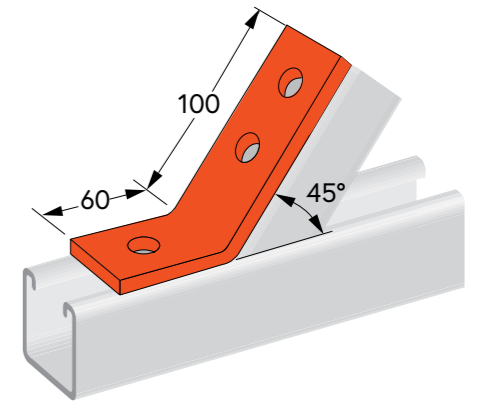

FDG1035G

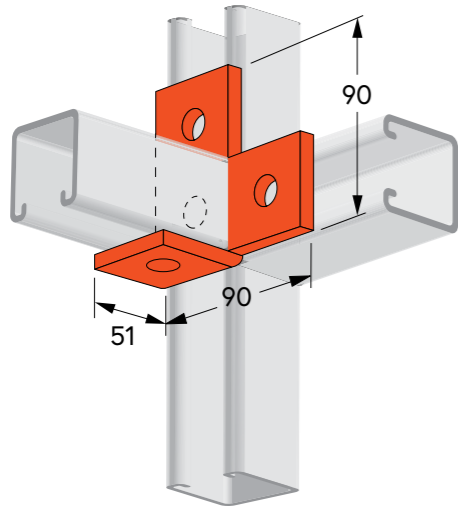

FDG1357G

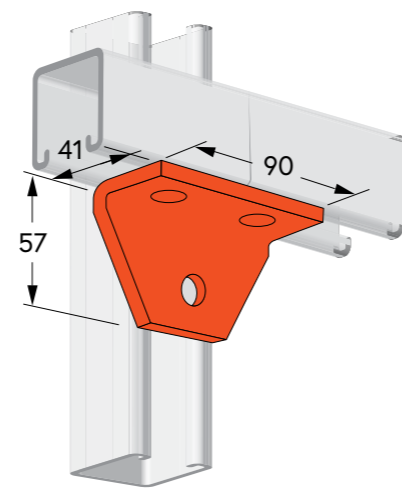

FDG4045G

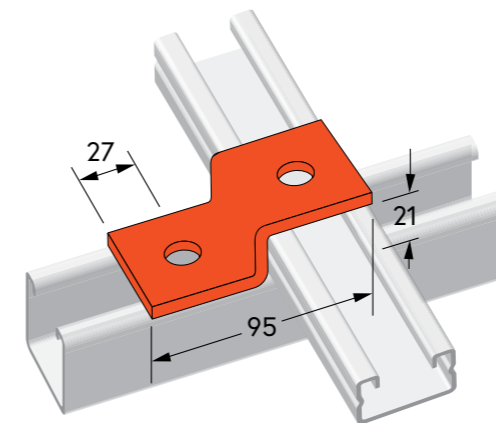

FDG1045G

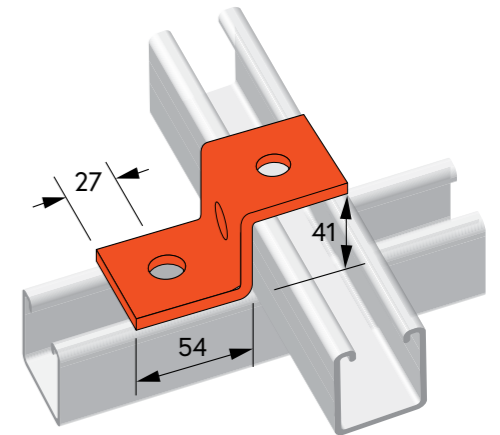

FDG1359G

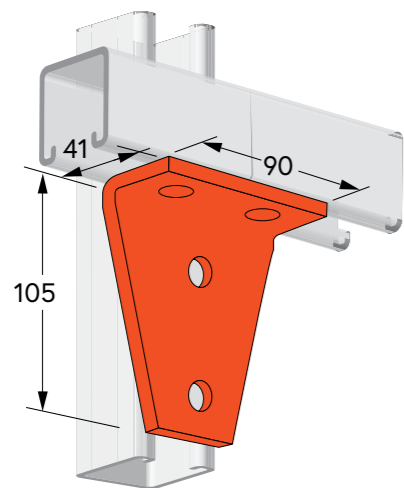

FDG1186G

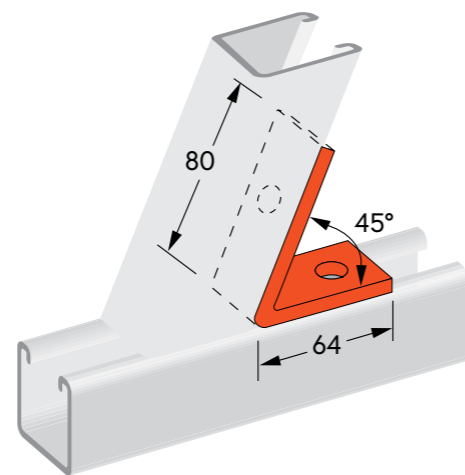

FDG1736G

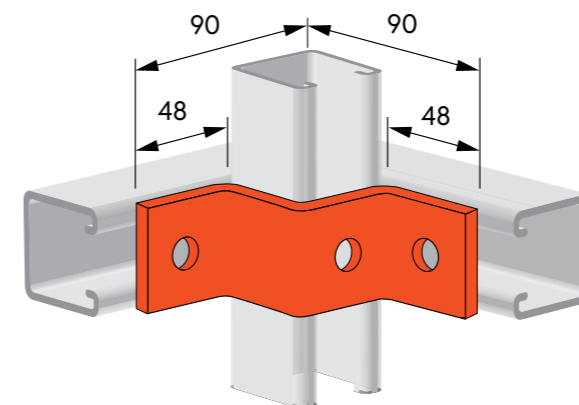

FDG2452G

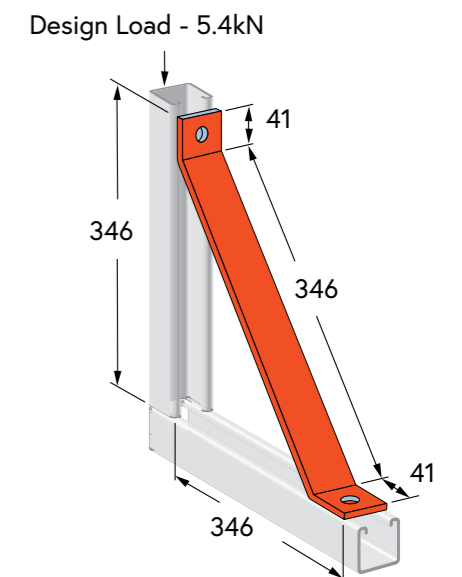

"Z", "U"

- Hole Diameter: 14mm
- Hole Spacing (From End): 21mm
- Hole Spacing: 48mm
- Width: 40mm
- Thickness: 6mm
- Finish: Hot Dip Galvanised

"U" & Wing Shape

- Hole Diameter: 14mm
- Hole Spacing (From End): 21mm
- Hole Spacing: 48mm
- Width: 40mm
- Thickness: 6mm
- Finish: Hot Dip Galvanised

FDG5545G

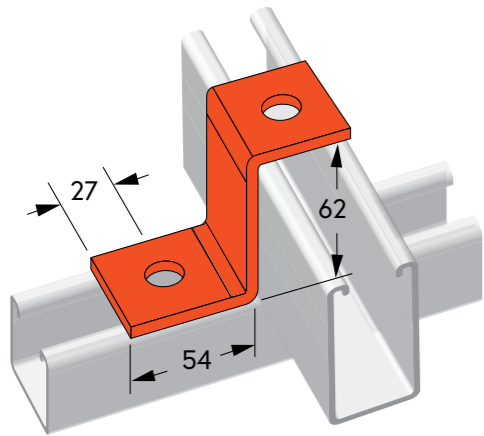

FDG1453G

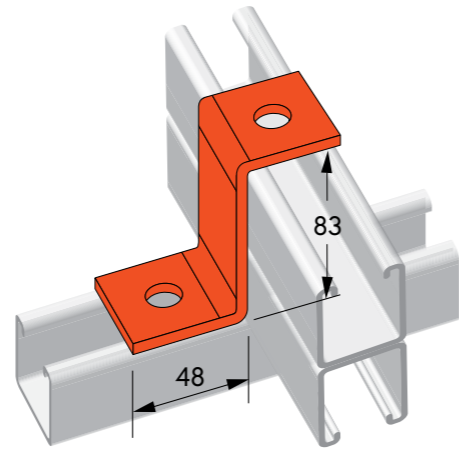

FDG2223G

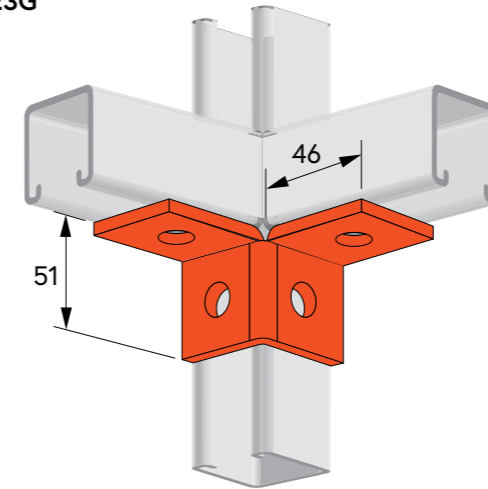

FDG1044G

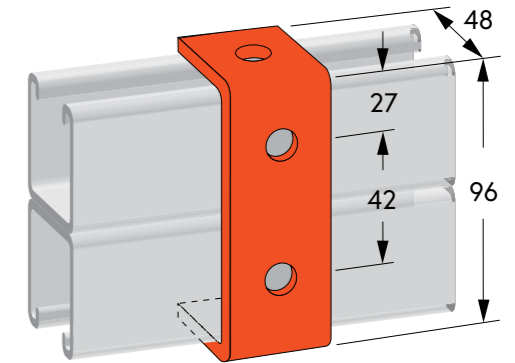

FDG4047G

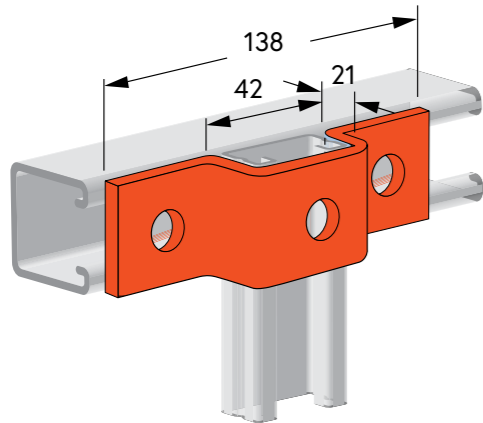

FDG1047G

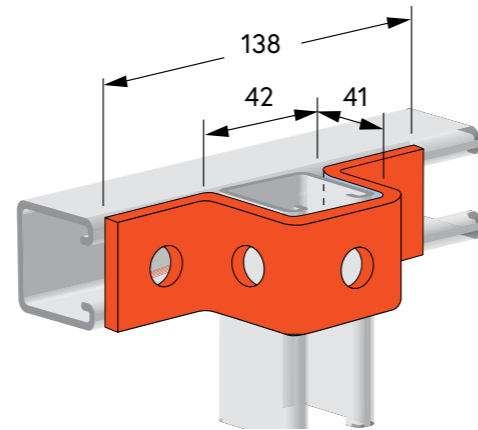

FDG1046G

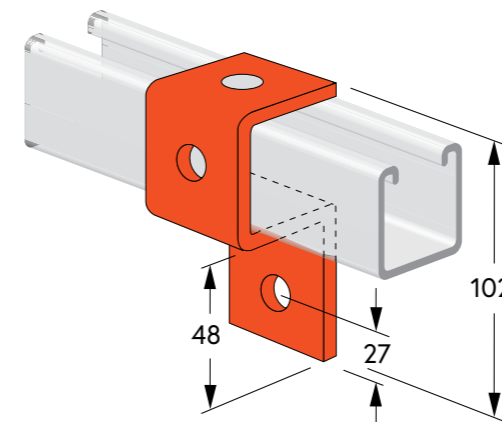

FDG4376G

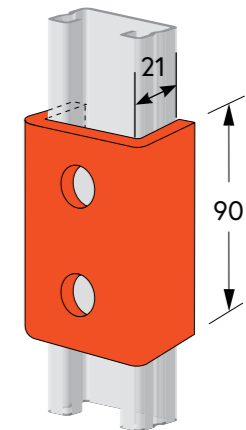

FDG5547G

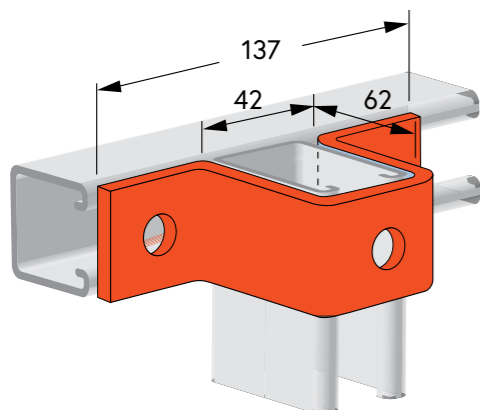

FDG1737G

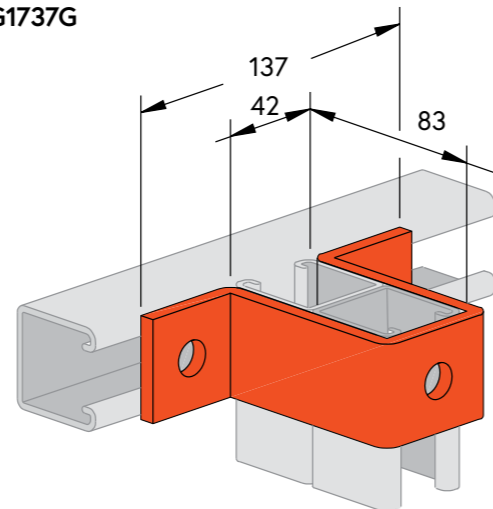

FDG1376G

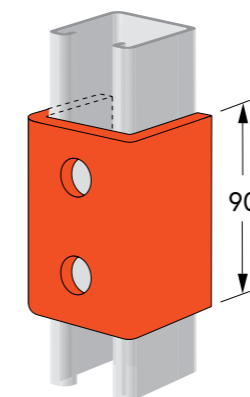

FDG1377G

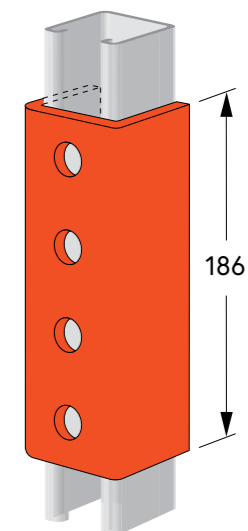

Wing Shape

- Hole Diameter: 14mm
- Hole Spacing (From End): 21mm
- Hole Spacing: 48mm
- Width: 40mm
- Thickness: 6mm
- Finish: Hot Dip Galvanised

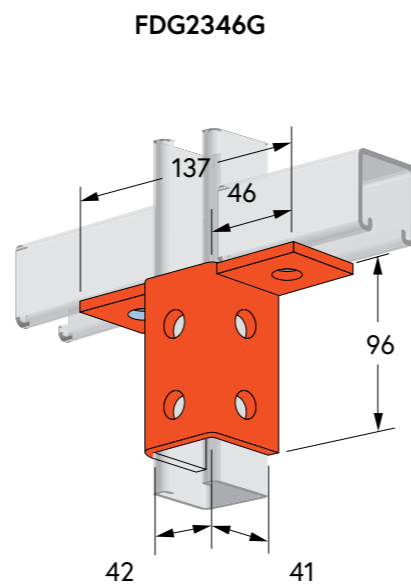
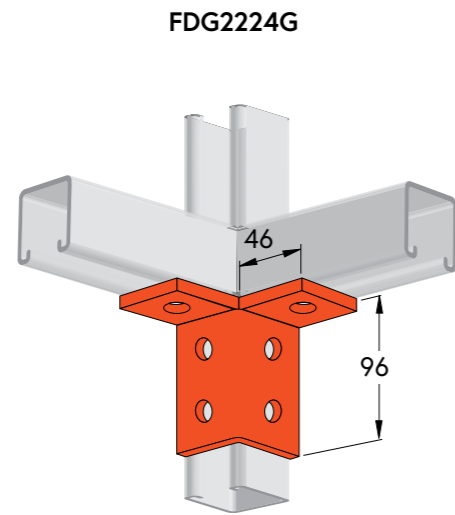
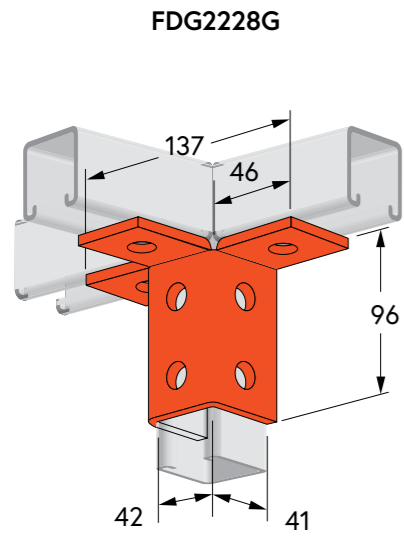

Base Plates

- Hole Diameter: 14mm
- Hole Spacing (From End): 21mm
- Hole Spacing: 48mm
- Width: 40mm
- Thickness: 6mm
- Finish: Hot Dip Galvanised

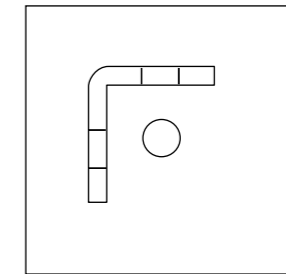
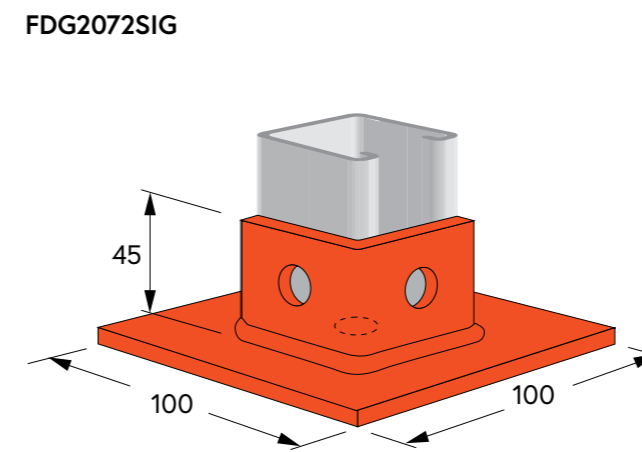

FDG2072BG & FDG2072AG

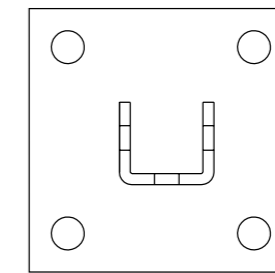
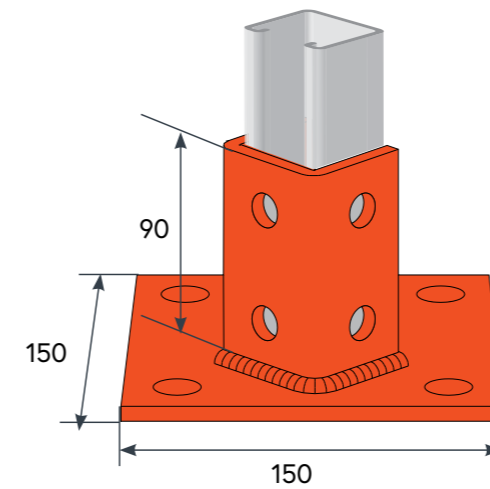

FDG2072G

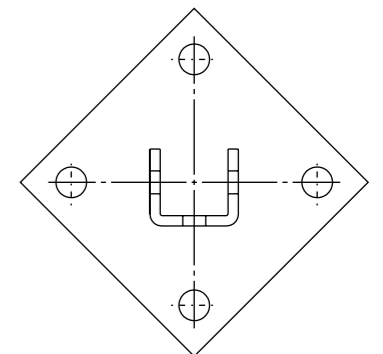

FDG2072AG

Adjustable Brace Fittings

- Hole Diameter: 14mm
- Hole Spacing (From End): 21mm
- Hole Spacing: 48mm
- Width: 40mm
- Thickness: 6mm
- Finish: Hot Dip Galvanised

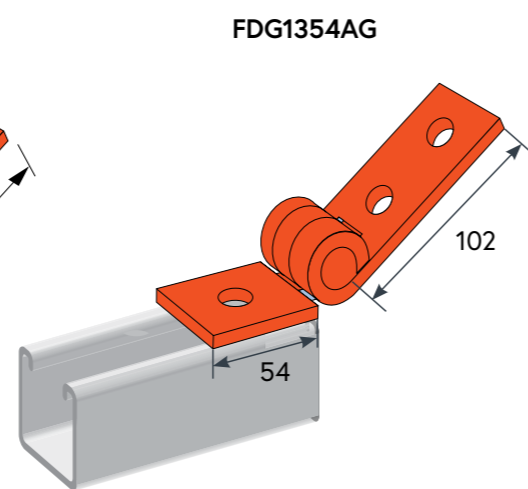
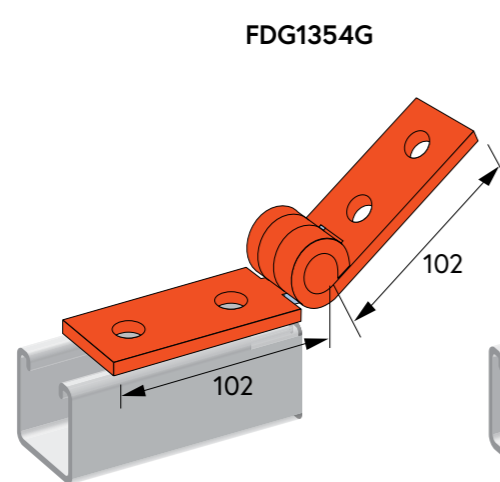
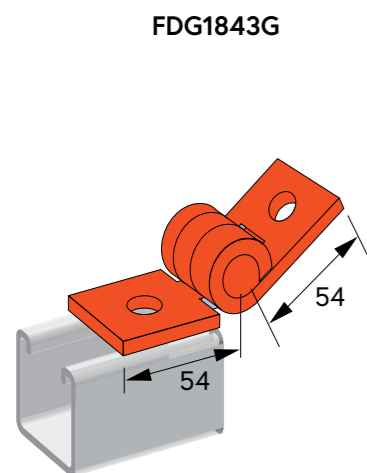

FDG2073BG & FDG2073AG

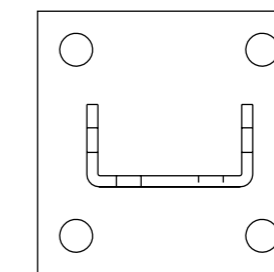
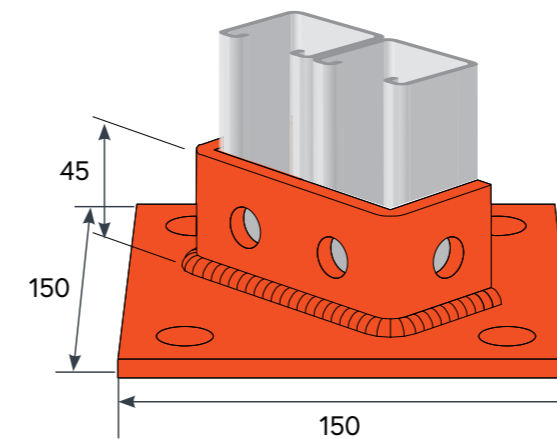

FDG2073G

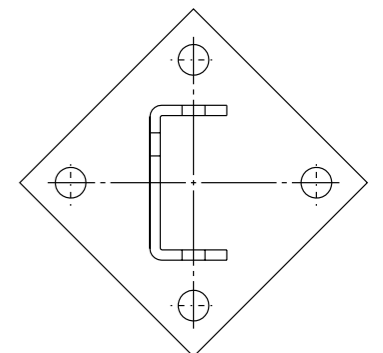

FDG2073AG

Beam Clamps

FDG1386G

- **Design Load:** 2.5 kN (Using the FDG1000 channel)
- **Finish:** Hot Dip Galvanised

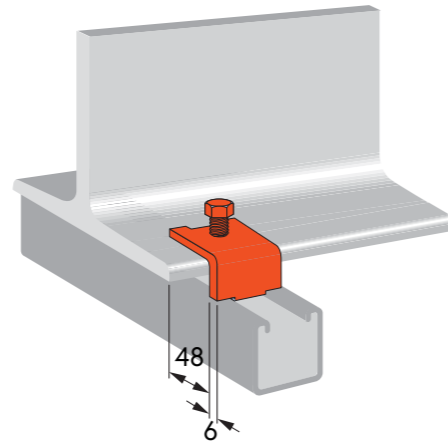

- M12 x 40 bolt and channel nut not included.
- Ensure these brackets are used in pairs.

FDG1379G

- **Design Load:** 2.5 kN (Using the FDG1000 channel)
- **Finish:** Hot Dip Galvanised

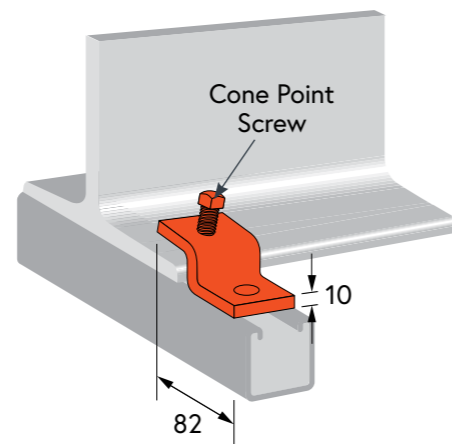

- M12 x 40 cone point screw included.
- Ensure these brackets are used in pairs.

FDG2785G & FDG2786G

FDG2785G (Works with FDG1000 & FDG3300)

- **Leg Length:** 86mm
- **Design Load:** 4.5 kN each
- **Finish:** Hot Dip Galvanised

FDG2786G (Works with FDG1001 & FDG5500)

- **Leg Length:** 127mm
- **Design Load:** 4.5 kN
- **Finish:** Hot Dip Galvanised

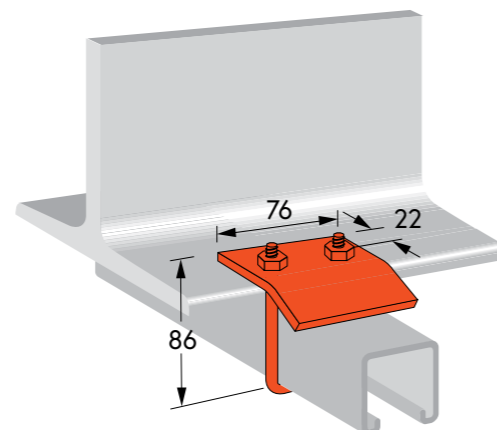

- Ensure these brackets are used in pairs.

Beam Clamps

FDG1796G

- **Design Load:** 2.5 kN (Using the FDG1000 channel)
- **Finish:** Hot Dip Galvanised

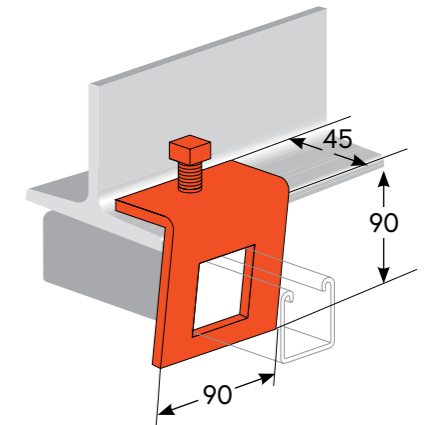

- M12 x 40 cone point screw included.
- Ensure these brackets are used in pairs.

FDG1272G

- **Design Load:** 2.0 kN
- **Finish:** Hot Dip Galvanised

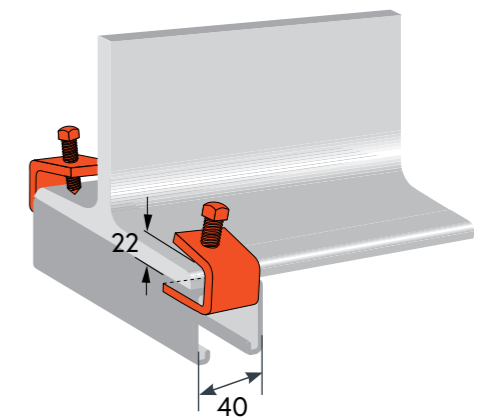

- M12 x 40 cone point screw included.
- Ensure these brackets are used in pairs.

FDG3087G

- **Design Pull-out Load:** 4.5 kN (Using FDG1000)
- **Design Slip Load:** 3.5 kN (Using FDG1000)
- **Finish:** Hot Dip Galvanised

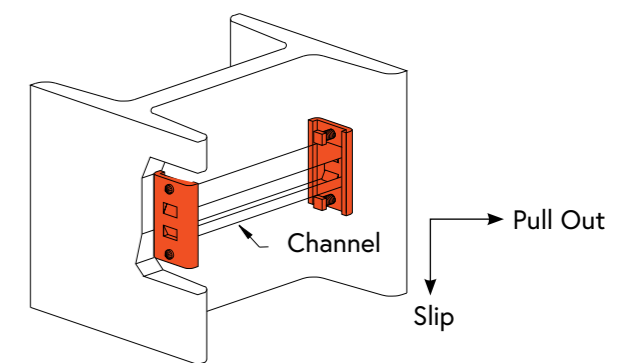

- Ensure these brackets are used in pairs.
- M12 x 40 cone point screw included.

Cantilever Brackets

- Hole Size: 14mm
- Finish: Hot Dip Galvanised

Braced Cantilever Bracket		
Code	Length	Design Load - UDL
FDGCB320G	320 mm	8.81 kN
FDGCB470G	470 mm	3.43 kN
FDGCB635G	635 mm	3.38 kN
FDGCB780G	780 mm	1.72 kN
FDGCB930G	900 mm	1.47 kN
FDGCB1080G	1080 mm	0.85 kN

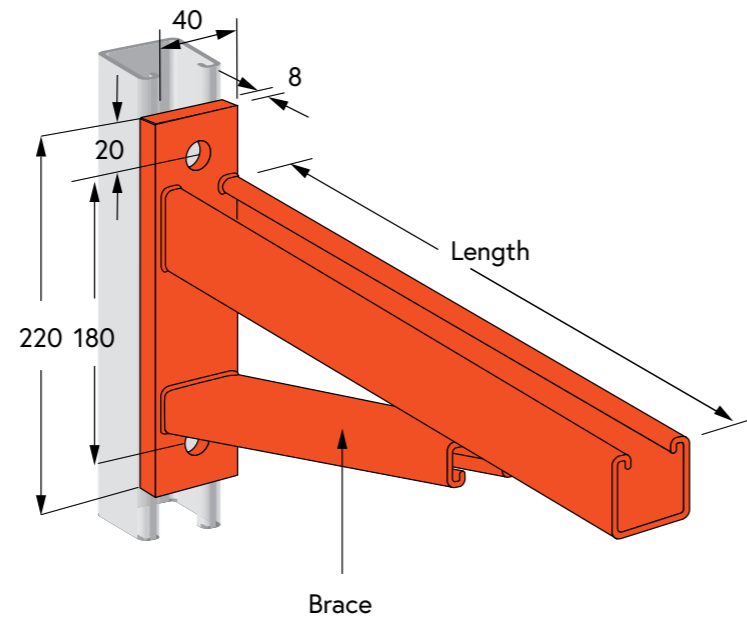

Cantilever Brackets

- Hole Size: 14mm
- Finish: Hot Dip Galvanised

Back to Back Cantilever Bracket		
Code	Length	Design Load - UDL
FDGCB2B305G	305 mm	7.50 kN
FDGCB2B460G	460 mm	5.20 kN
FDGCB2B610G	610 mm	4.10 kN
FDGCB2B760G	760 mm	3.20 kN
FDGCB2B915G	915 mm	2.65 kN

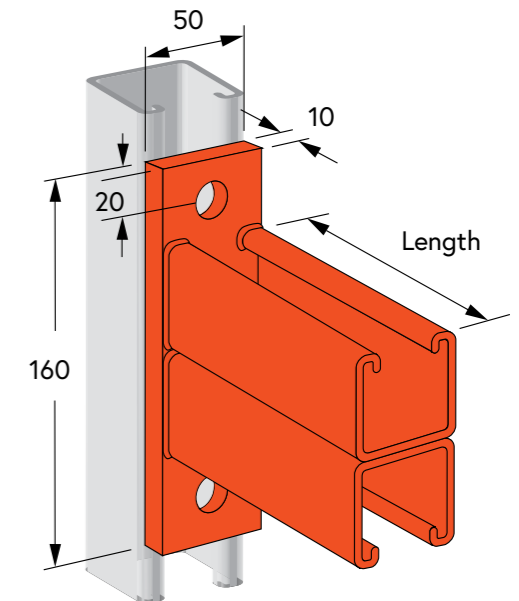

Un-Braced Cantilever Bracket		
Code	Length	Design Load - UDL
FDGCBU150G	150 mm	4.85 kN
FDGCBU300G	300 mm	2.35 kN
FDGCBU450G	450 mm	1.60 kN
FDGCBU600G	600 mm	1.25 kN
FDGCBU750G	750 mm	1.05 kN
FDGCBU900G	900 mm	0.75 kN
FDGCBU1000G	1000 mm	0.55 kN

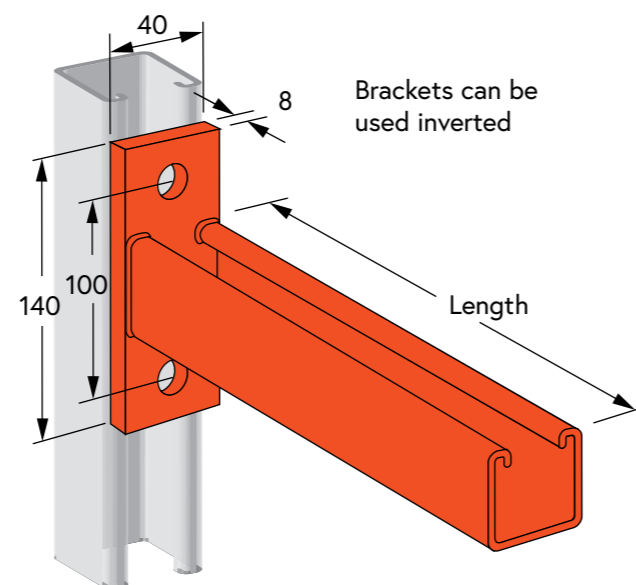

FDG5500G Cantilever Bracket		
Code	Length	Design Load - UDL
FDGCBH300G	300 mm	6.95 kN
FDGCBH450G	450 mm	4.80 kN
FDGCBH600G	600 mm	3.60 kN
FDGCBH750G	750 mm	2.90 kN

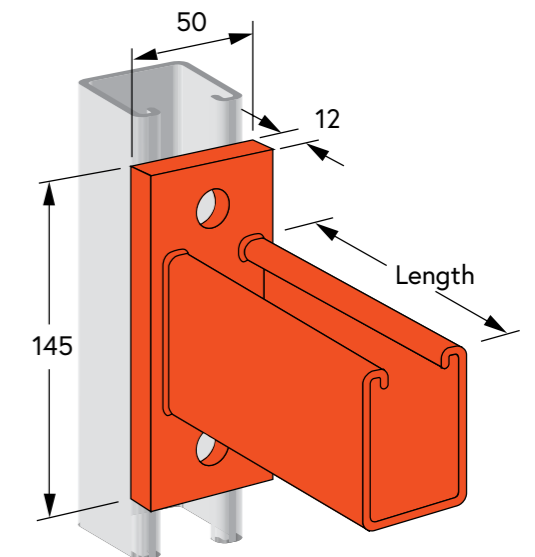

Notes

Notes

sales@fdgnz.com

20 Minsel Dr, Warkworth, Auckland 0910 New Zealand

09-275-6811